

## ATACAMA EXPEDITION TENT - SET UP INSTRUCTIONS

Your Atacama Expedition Tent is easy to pitch and maintain. Follow these instructions to set up your tent quickly, safely and easily. In order to familiarize yourself with your new tent, we suggest that you test pitch it before setting off on an expedition.

- Find a site that is even, protected from the wind and without any sharp objects.
- Remove any sharp rocks or sticks that can damage your tent floor.
- Avoid hollow spots where rain water can gather.

1

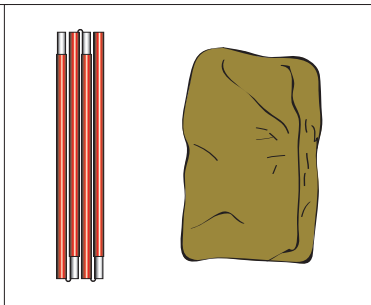

### UNPACK TENT

#### CONTENTS:

- Inner Tent & Outer Tent (arrive already clipped together).
- Pole Bag (3 Tent Poles. 2 quantity red, long 2x11mm poles and 1 quantity grey, short 1x9.5 mm pole).
- Stake Bag (1).

2

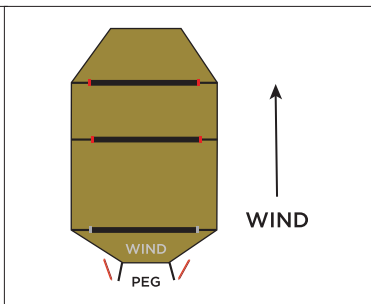

### UNROLL TENT

Face end marked 'WIND' into wind and peg this end, one stake in each of the 2 black loops.

3

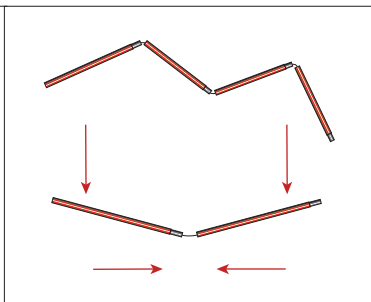

### REMOVE POLES FROM THE POLE BAG

The Atacama Expedition Tent comes with 3 main poles, the two longer red, larger diameter poles are for the garage end. The shorter grey pole is for the sleeping area of the tent.

Assemble the Poles. Carefully unfold the shock corded sections and allow them to slide together. Do not snap the pole sections together, this will damage the poles. Make certain that the insert of each pole section is fully inserted into the next section. Failure to do so may cause your poles to crack.

# REDVERZ

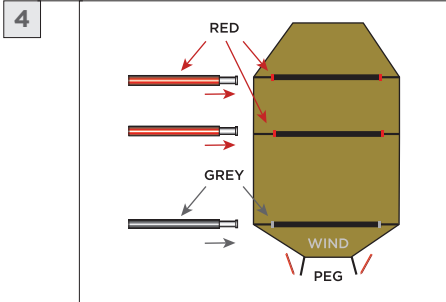

## MATCH POLES

Match poles with their corresponding pole loop. Red poles slide into sleeves with red tabs, grey pole to grey tab.

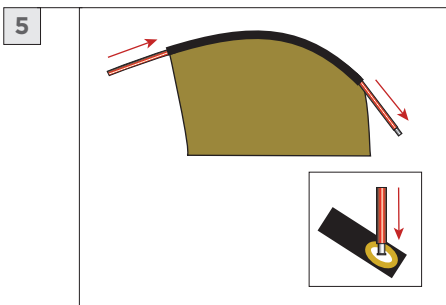

## INSERT POLES

Gently slide each pole through the sleeve, and insert the pole tip into the grommet. Slide the sleeve material over the bending pole and place the other tip into the opposite grommet. Repeat for the other poles. The tent is now pegged at one end, and lying down with poles fully inserted.

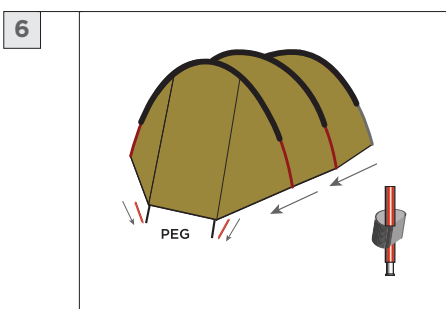

## ERECT THE TENT

Pull the 2 black loops on the garage or opposite end of tent. Peg this end down with one stake in each of the 2 black loops. Clip tent to poles.

The tent comes with guy lines for use in high winds. It is imperative to peg down the lines as far as possible from the tent for best results in strong wind. They should however not be pulled so tight that they distort the natural shape of the tent.

**TAKE DOWN AND PACKING.** Start by sweeping out all dirt from the inner tent. Close all zippers. Pull up all ground pegs except the ones at the end facing the wind. **PUSH OUT THE POLES!** Do not attempt to pull out the poles because the sections will separate from each other making it difficult to get them out! When the poles have been taken out pull up the remaining pegs, fold and roll up the tent. Make sure that while rolling the tent, air is gently escaping from it. You can also simply stuff the tent into its bag and pack away the poles and pegs bags by themselves.

**DRYING AND CARING FOR YOUR TENT.** It is important that you do not store a tent without completely drying it first except for a short period (during a trip). After use it should be hung in a dry and well-vented spot. Failure to properly dry all tent components before storing your tent can lead to molding. Stains should be cleaned with luke warm water. Clean and/or replace lost ground pegs. If the tent needs cleaning use only luke warm water. Avoid pitching your tent for long periods in direct sunlight since UV-light damages all fabrics.

**USE OF OUTER SEPARATELY.** The tent is designed to be used without the inner. To remove the inner tent, just unclip it. Pitch the outer tent by itself following the same instructions as with the complete tent. Clip the optional footprint inside the outer tent to stabilize.

Use a footprint, sold separately, to protect your inner tent from ground moisture, dirt and sharp objects.

**ALWAYS LEAN MOTORCYCLE AWAY FROM SLEEPING COMPARTMENT**